



LEA MAY, MS, LMFT-S, RPT-S

Lea is a graduate of the University of Central Oklahoma specializing in Play Therapy. She is a supervisor for Marriage and Family Therapy licensure. Lea currently is owner and a practitioner of Instilling Hope LLC, a private practice in Oklahoma City, OK.



NANCY RUMLEY SOLIZ, MS, LMFT, RPT-S

Nancy is a graduate of Kansas State University with a Master's degree in Family Studies and Human Services. She is both a supervisor for Marriage and Family Therapy licensure, and Registered Play Therapy certification. Nancy is currently in private practice in northwest Oklahoma City with the Family Solutions Counseling group.

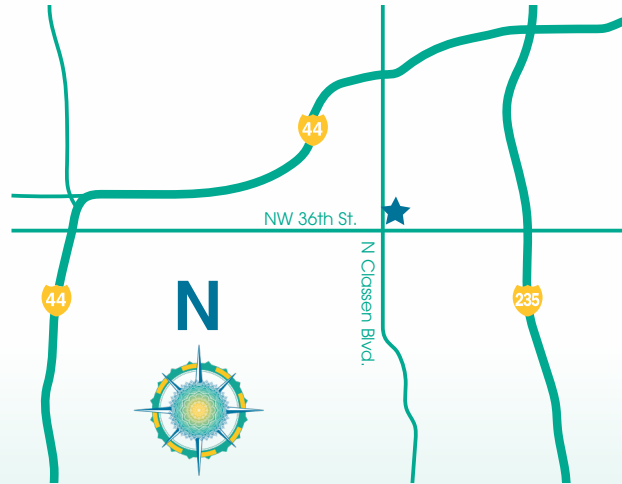

CONTACT US

Oklahoma Play Therapy
Training Institute
3700 N. Classen, Suite 185
Oklahoma City, Ok 73118

405.413.4768

<http://instillinghopellc.com/oklahoma-play-therapy-training-institute/>
oklahomaplaytherapy@gmail.com

CANCELLATION AND REFUND POLICY

- If OPTTI cancels a training, we will refund registration fee or participant can decide to use that as a credit to an upcoming training.
- Individuals who wish to enter the complete program must complete application. All application fees are nonrefundable.
- Individual course cancellations received at least 5 days prior to scheduled training are refundable less a \$35 administrative fee.
- Cancellations received within 5 days prior to a scheduled training will not be refunded.
- Missed training (no shows) will not be given a refund.
- Must attend entire training, partial CE credit is not available.

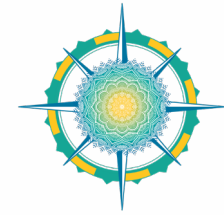

**OKLAHOMA PLAY THERAPY
TRAINING INSTITUTE**

expanding the power of play



**PLAY THERAPY COURSES
AND SUPERVISION**

APT Provider 17-491

WELCOME

Oklahoma Play Therapy Training Institute offers play therapy trainings to help service providers feel more confident in their work and increase the number of skilled play therapists in our community.

TRAINING OPPORTUNITIES

PLAY THERAPY PROGRAM

Two year program that includes 150 contact play therapy credit hours and 35 hours of supervision by a RPT-S.

ADDITIONAL CONTINUING EDUCATION OPPORTUNITIES

Various topics surrounding play therapy, including working with diverse populations, ethics, and supervision.

Program has been developed for Licensed professionals

- LMFT
- LPC
- LCSW
- Master's level school based counselors
- Candidates for licensure*
- Master's level students in a counseling clinical program*

*Must have state clinical license before obtaining RPT.

LEARNING OBJECTIVES AND COURSE DESCRIPTIONS ARE FOUND ON THE WEBSITE

PROGRAM COURSES

PHASE I

INTRODUCTION TO PLAY THERAPY Sept. 10-11, 2021

THEORIES AND ETHICS OF PLAY THERAPY Nov. 5-6, 2021

ASSESSMENT, TREATMENT PLANNING, AND TECHNIQUES IN PLAY THERAPY Jan. 7-8, 2022

PHASE II

FAMILY PLAY THERAPY Mar. 4-5, 2022

USE OF SANDTRAYS IN PLAY THERAPY May 6-7, 2022

LIFESPAN APPLICATIONS OF PLAY THERAPY Oct. 7-8, 2022

CULTURAL AND ETHICAL CONSIDERATIONS IN PLAY THERAPY Dec. 2-3, 2022

PHASE III

ROLES OF ATTACHMENT IN PLAY THERAPY Feb. 3-4, 2023

WORKING WITH ABUSE AND TRAUMA IN PLAY THERAPY Apr. 14, 2023*

INTEGRATING NEUROSENSORY AND MINDFULNESS IN PLAY THERAPY June 2-3, 2023

PROFESSIONAL AND ETHICAL DEVELOPMENT IN PLAY THERAPY June 23, 2023*

REGISTRATION FOR COURSES ARE DIVIDED INTO TWO GROUPS: COHORT GROUP

Application necessary, includes all 150 hours of courses in addition to 35 hours of supervision

INDIVIDUAL COURSE GROUP

Participant does not want to attend all courses or receive any supervision. Participant signs up for individual course(s), no application necessary

PROGRAM AGENDA

FRIDAYS (7 HOURS/ 1 HOUR SUPERVISION)

Supervision: 11:00 AM to 12:00 PM

Training: 1:00 PM to 2:45 PM

Break: 2:45 PM to 3:00 PM

Training: 3:00 PM to 4:45 PM

Dinner: 4:45 PM to 5:15 PM

Training: 5:15 PM to 7:00 PM

Break: 7:00 PM to 7:15 PM

Training: 7:15 PM to 9:00 PM

SATURDAYS (8 HOURS)

Training: 8:30 AM to 10:30 AM

Break: 10:30 AM to 10:45 AM

Training: 10:45 AM to 12:30 PM

Lunch: 12:30 PM to 1:30 PM

Training: 1:30 PM to 3:30 PM

Break: 3:30 PM to 3:45 PM

Training: 3:45 PM to 6:00 PM

*COURSE SCHEDULE:

FRIDAY (7.5 HOURS/ .5 HOUR SUPERVISION)

Supervision: 11:00 AM to 11:30 AM

Training: 12:30 PM to 2:45 PM

Break: 2:45 PM to 3:00 PM

Training: 3:00 PM to 4:45 PM

Dinner: 4:45 PM to 5:15 PM

Training: 5:15 PM to 7:00 PM

Break: 7:00 PM to 7:15 PM

Training: 7:15 PM to 9:00 PM

SUPERVISION

- 10 hours of FREE group supervision is provided for those in the cohort before every Friday class from 11:00 AM to 12:00 PM.
- 25 hours of individual supervision is provided at a reduced rate for those in the cohort group.

"Whoever wants to understand much must play much." – Gottfried Benn